



Model: SPA-G161

Installation guide







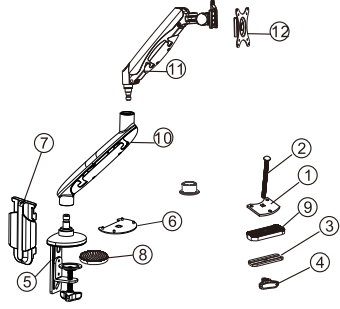

①	Perforated plate	1PCS
②	Long screw	1PCS
③	Knob nut	1PCS
④	Pressure plate	1PCS
⑤	Base mounting plate	1PCS
⑥	Protection pad 1	1PCS
⑦	Wire buckle plastic cover	1PCS
⑧	Protection pad 2	1PCS
⑨	Protection pad 3	1PCS
⑩	Bottom arm	1PCS
⑪	Upper arm	1PCS
⑫	Panel	1PCS







STEP 1

The Preparation Before Monitor Installation

1.Make sure there are VESA holes 100x100mm or 75x75mm in the monitor. If not, the mount installed.
2.Remove the original fixed base of monitor.Be careful not to scratch the screen.

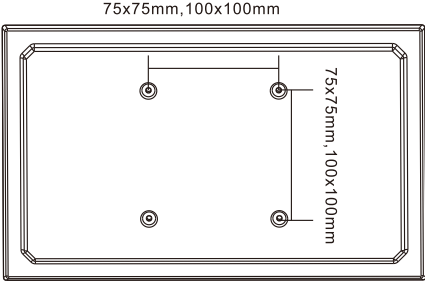

STEP 2-A

Option1:

For desk thickness: 20-100mm

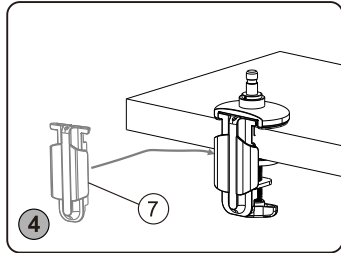
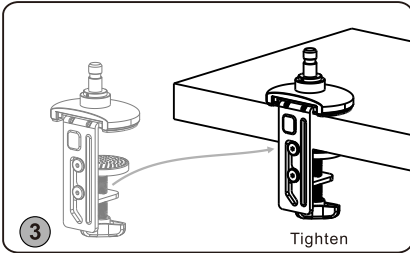
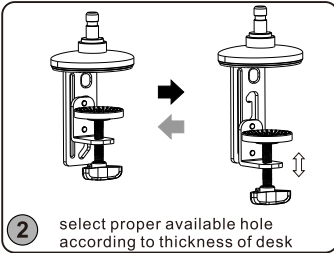
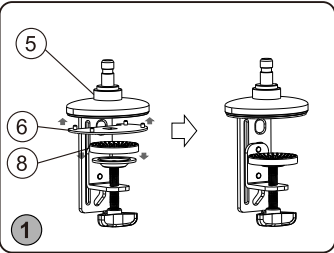

STEP 2-B

Option2: Grommet

Available hole size:8.5-70mm

For desk thickness:20-100mm

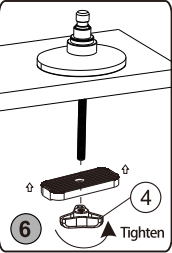
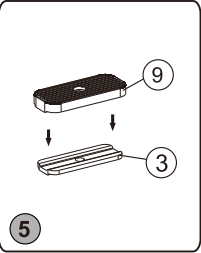
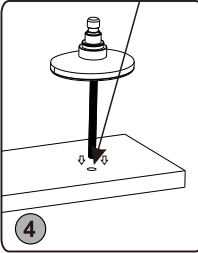
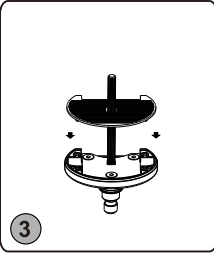
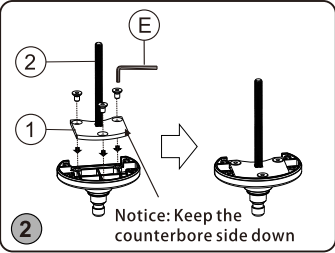
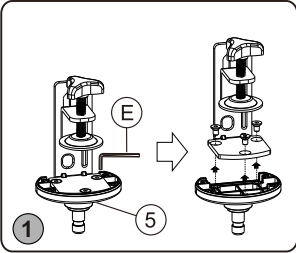

STEP 3

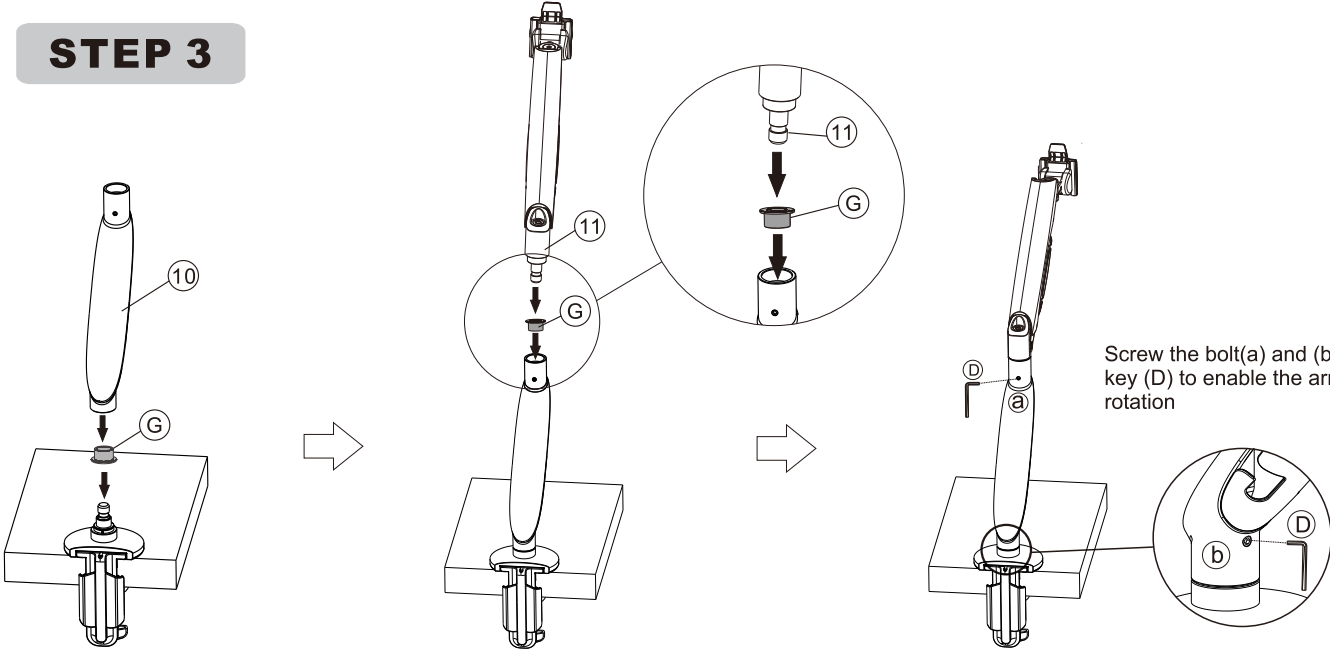

Screw the bolt(a) and (b) by allen key (D) to enable the arm a smooth rotation

STEP 4

Connect the plate and monitor

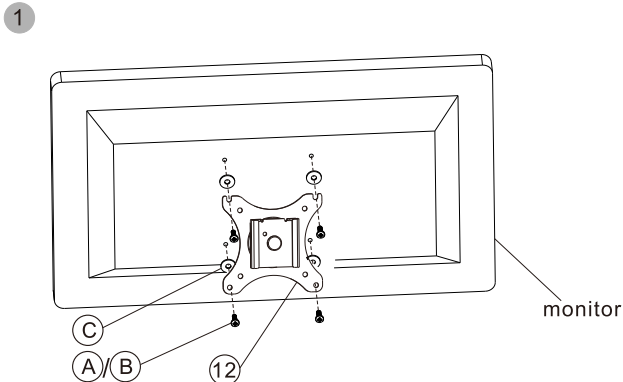

Use washer if needed

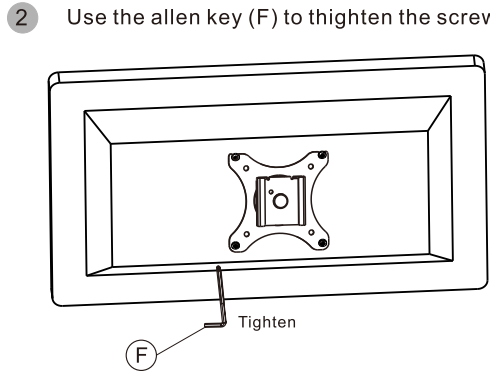

STEP 5

Install the monitor to the arm

Hang the monitor on the plate from top to bottom and ensure it be tightened

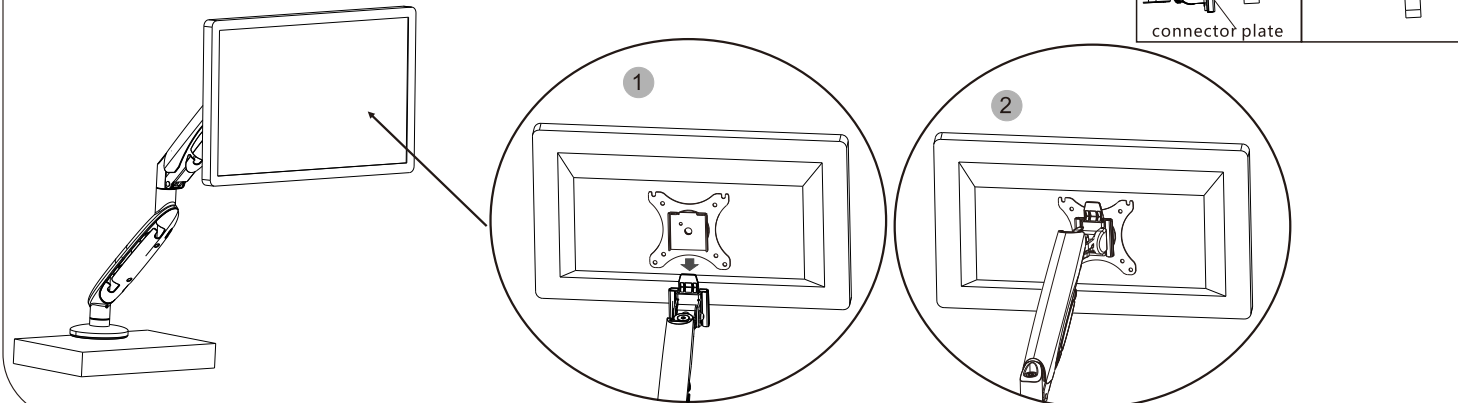

STEP 7

Adjust the monitor

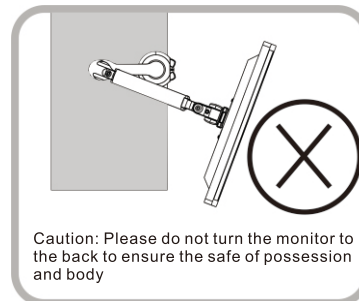

⚠ Loading capacity of gas spring preset is 5-7kg

Adjust monitor height according to preference. Adjust the scw in "-"direction when the monitor up and "+"direction when it down.

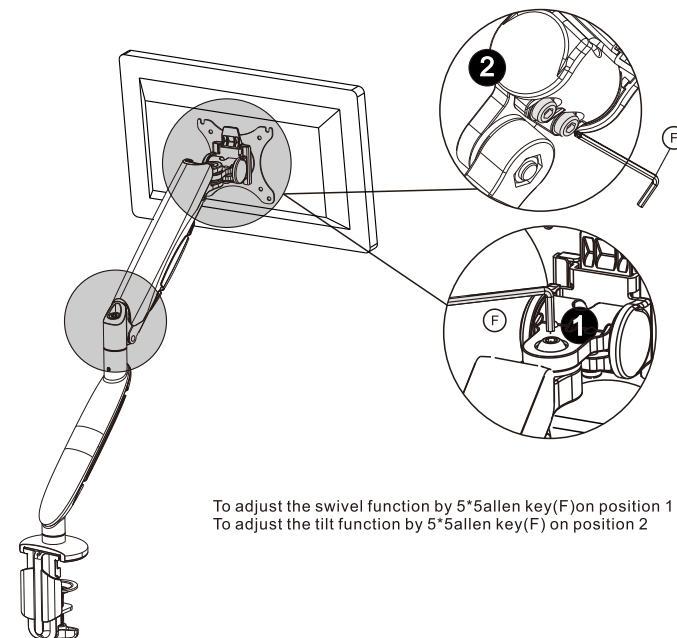

To adjust the swivel function by 5*5allen key(F) on position 1
To adjust the tilt function by 5*5allen key(F) on position 2

Using cord management

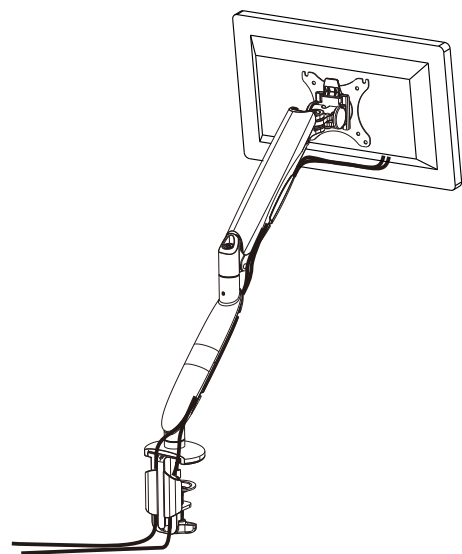

Specification

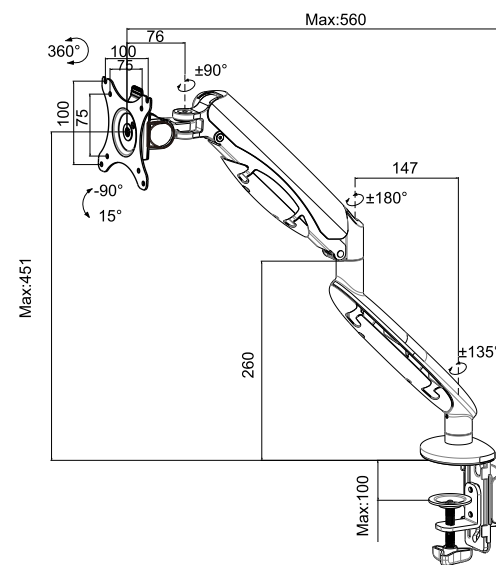

CAUTION

This product contains small items that could be a choking hazard if swallowed.Keep these items away from young children.

- Make Sure these instructions are read and completely understood before attempting installation.If you are unsure of any part of this installation,please contact a professional installer for assistance.
- The desk or mounting surface must be capable of supporting the combined weight of the mount and the display,otherwise the structure must be reinforced.
- Safety gear and proper tools must be used.A minimum of two people are required for this installation.Failure to use safety gear can result in property damage,serious injury or death.
- please check joint parts every two months,making sure the screws are loosened or not.

This product was designed to be installed on desk.Before installing, make sure the mount will support the combined load of the equipment and hardware. Never exceed the maximum load capacity 12 KG, or else it may result in product failure or personal injury.

Note:this product is intended for indoor use only.Use of this product outdoors could lead to product failure or personal injury.

Warning: This product contains high pressure gas spring parts, please do not put it into fire, high temperature, or disassemble it, which will lead to unexpected personal injury. The obsolete products can be sent back to the manufacturer or handed over to professional institutions.

To ensure the sealing performance of the gas spring, it is suggested to have complete adjustment to the upper arm (with spring) one time or several times every month.

Made in ChRL for
DMTrade Mikołaj Tomaszewski
Wiśniowa 36, 64-000 Kościan, Poland

NIP: PL6981681757
email: sklep@dmtrade.pl
phone #1: +48 661 082 052
phone #2: +48 726 082 052

www.ergoline.spacetronek.eu