

maxkin[®]

Smart Security, Always Connected



Products Presentation 2018

Achieved 'FINALIST' Status at
IFSEC's Security & Fire
Excellence Awards 2014,2016



N8

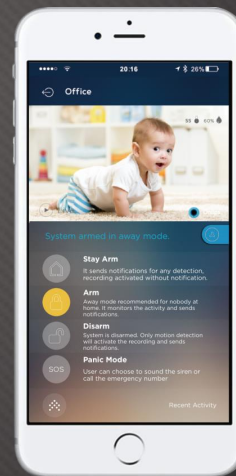

Innovative Technology

- WiFi/GSM Dual-Network
- FHSS Hopping Frequency, Anti-Interference Solution
- Integrated Camera & Alarm
- All-in-One Mobile App for All Security Device





Intelligent Motion Detection

Arm the system, both PIR and Photoelectric Detects movement are triggered, then it will activate the real alarm. It effectively reduce the false alarm.



Wi-Fi + GSM,
Double Safety



Sim Card
Required

1st Communication: WiFi

2nd Communication: GSM backup for alarm system

Users will get SMS & phone call. No video

Main Feature



Wi-Fi + GSM,
Double Safety



Immediate
SMS Alerts



FHSS Hopping
Frequency



3 SMS, 5 Phone No. 10 Hours
2 CMS Phone No. Battery Back-up

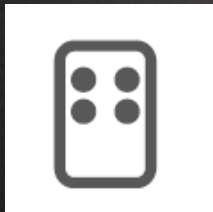

Customizable
Keyfob Name

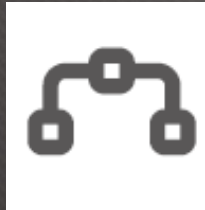

50pcs Sensors
Added On

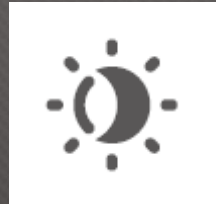

24 Hours
Protection



Entry/Exit
Delay

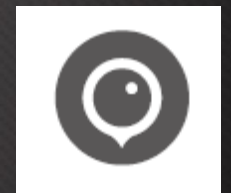

iOS & Android App
Easy to Setup

Control Panel

SOS Panic Button

Trigger 110dB loud siren for any emergency

Temperature &
Humidity Sensor It allows you
to track your home's
temperature & humidity.

1080P HD Camera

High quality video that captures
every details

Built-in Infrared Sensor

Detects human body motion

Built-in Microphone
Hi-Fi Two-way talk.

Photoelectric Detection

To detect the light intensity.

4 Color LED Indicator

Showing arm/disarm/alarming status





For Multiple Devices



WiFi/GSM
SmartCam Alarm System



WiFi
Alarm System



WiFi
Security Camera

Ontips Pro-User Management



Authority	Admin	Owner	Senior	Kid
Add/Delete Users Manage Devices	√	X	X	X
Programming	√	√	X	X
Notification	√	√	√	X
Alarm Control Arm/Disarm...	√	√	√	√
Recent Activity	√	√	√	X
View Videos	√	√	√	X

Device



Conch
WiFi ALARM



Hybrid
HYBRID SMARTCAM



Telecamera 1
IP CAMERA



ALARM365TEST2
HYBRID SMARTCAM



Alarm Status (Arm, Disarm, Stay Arm)

Single Head: Admin,
Double Head: Shared Devices

Change Device Name
Delete Device

Grey: Offline; Lit: Online

Refreshing Device Status

Control & Alarm Notification

Four Ways to Control Your Security Alarm System



Alarm Notification



	Push Notification	SMS	Call	Email	Mark
SmartCam WiFi ON	√	×	√	√	Call phone number 1,2,3,4,5 If anyone pick up the phone, then it will stop calling next. If anyone disarm by clicking on button from notification window, then the call ends too.
SmartCam WiFi OFF	×	√	√	×	Call phone number 1,2,3,4,5 If anyone pick up the phone, then it will stop calling next.

Alarm Types



Entry Alarm

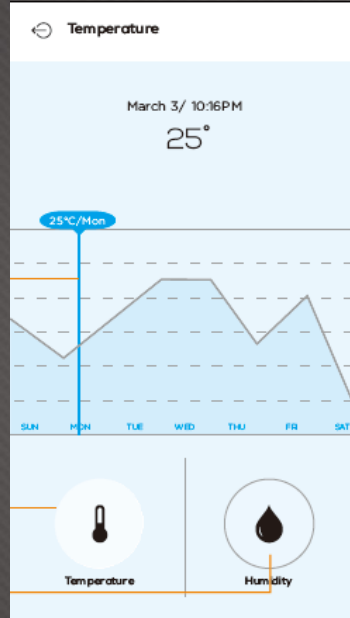

High & Low
Temperature Alarm



Glass Break
Vibration
Flood
Smoke

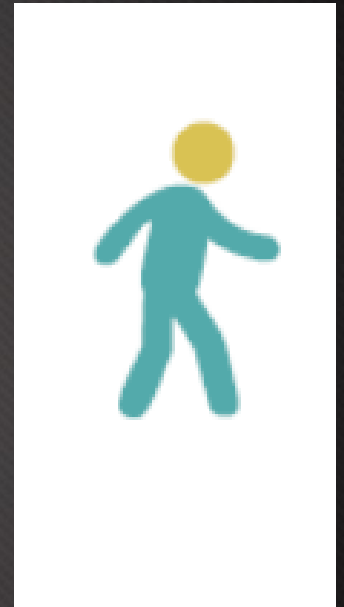

Motion Detection

Accessory Enrollment & Zone



Enroll by pressing the enroll button

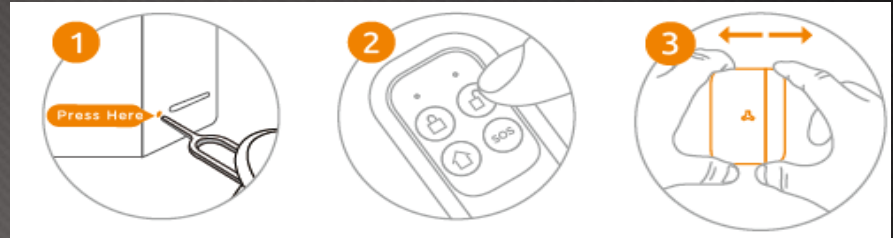

Enroll by pressing "+" on the apps

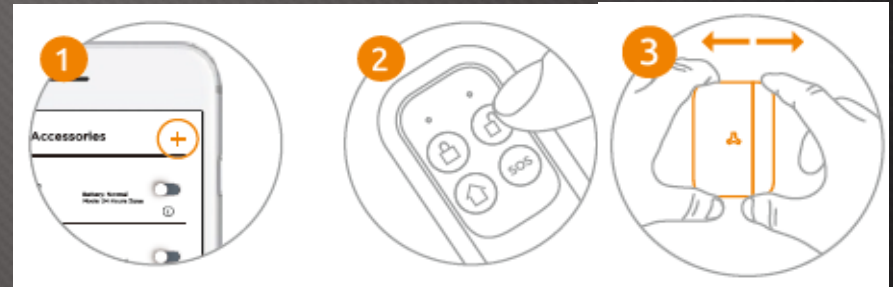

Zone for Accessories





Delay Zone: Allow a delay before the alarm is triggered

Normal Zone: Activate immediately when triggered

Home Mode Zone: Sensors are disabled when you press "Stay Arm"

24 Hour Zone: No matter when status, it will always trigger the alarm.

Comparing with latest security systems

Features	N8 	Canary 	Piper 	Nestcam 	Mark
1080P HD Camera	√	√	√	√	
Night Vision	√	√	√	√	
WiFi/GSM Dual Network	√	X	X	X	
Infrared Sensor	√	√	√	X	
Video Private Mode	√	√	X	√	
Two-Way Talk	√	√	√	√	
FHSS Hopping Frequency	√	X	X	X	RF anti-interference, more safe.
Two-way Sensors	√	X	X	X	Low battery, disconnected...
Full Alarm Operation	√	X	X	X	
SMS & Call Alert	√	X	√	X	
Backup-up Battery	√	X	√	X	
Support Door Sensor	√	X	√	X	50pcs different sensors can be expanded and named. Status can be seen on the apps.
Works with other detecting sensors	√	X	X	X	
SOS Emergency Call	√	X	X	X	More Added Value
CONTACT ID Protocol	√	X	X	X	Connects to Central Monitoring Station
Name Remote Control	√	X	X	X	Knows who's coming and going

Conch WiFi Alarm System





Home is where maxkin alarm system protect.

Main Feature



Plug & Play
Without complex wiring



Intuitive Control via App
Free Apps-easy to use



Real-time Push Notification
Remote control directly from
the app



Customizable Keyfob
Konw who's coming & going

LED Indicator

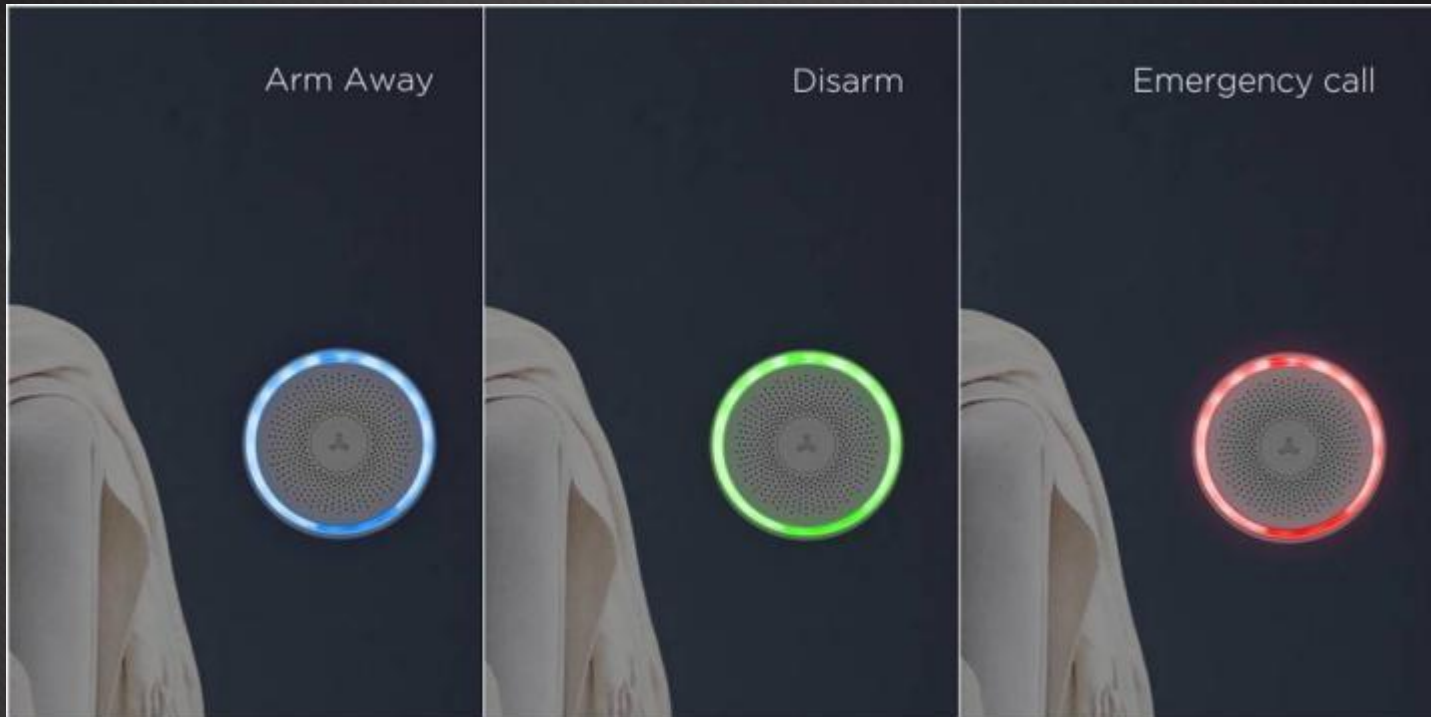

Red LED Flashes Once: Enrolling
Green LED On: System disarmed
Blue LED On: System armed in away mode.
Blue LED Flashes: System armed in stay mode.

Note: LED indicator flashes quickly when WI-FI network is off.

One Button Operation

Multifunctional button for network connection, accessory enroll, and device On/Off.

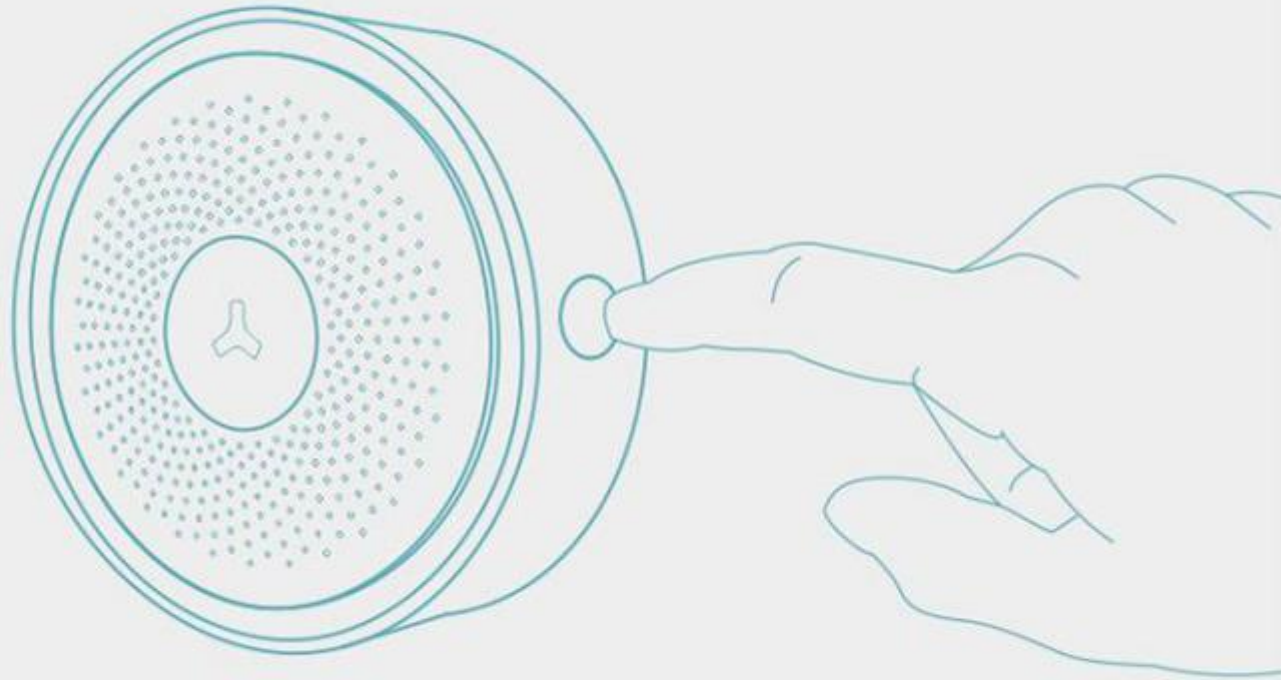

X1 GSM Alarm System

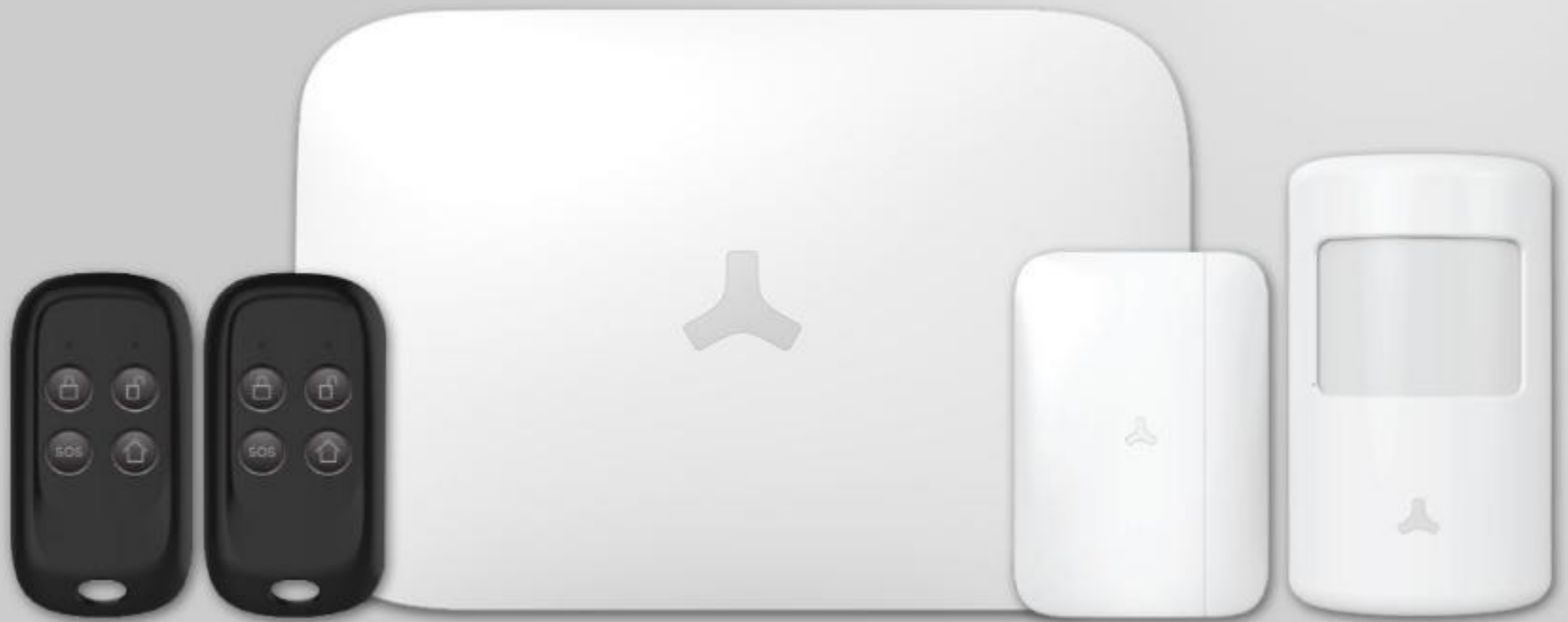

Working Status of Control Panel

White LED:
Arming / Disarming

Red LED:
Control Panel Status

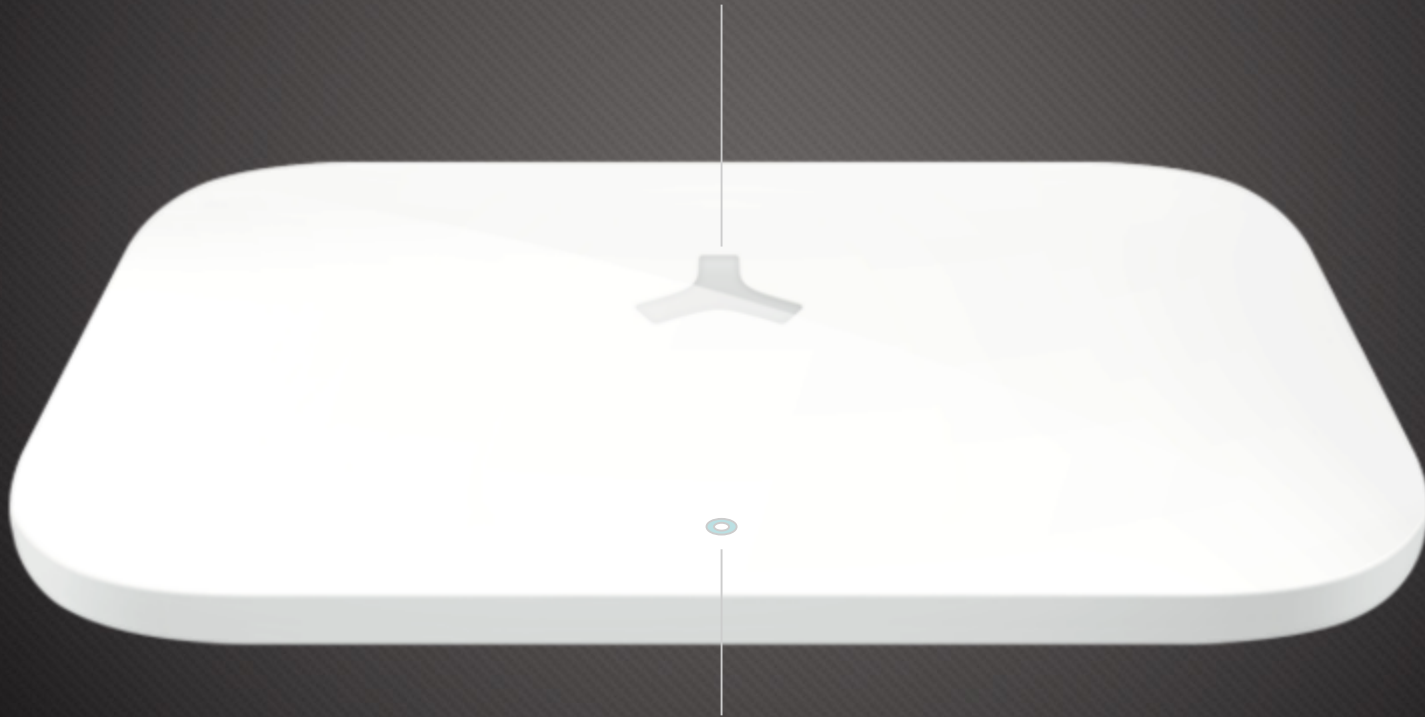

Green LED:
AC Power

Yellow LED:
GSM Signal Indicator

Four Ways to Control Your Security Alarm System

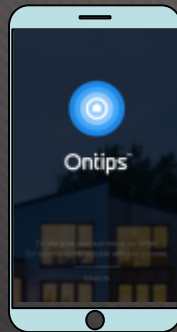

Overview of X1 GSM Alarm System

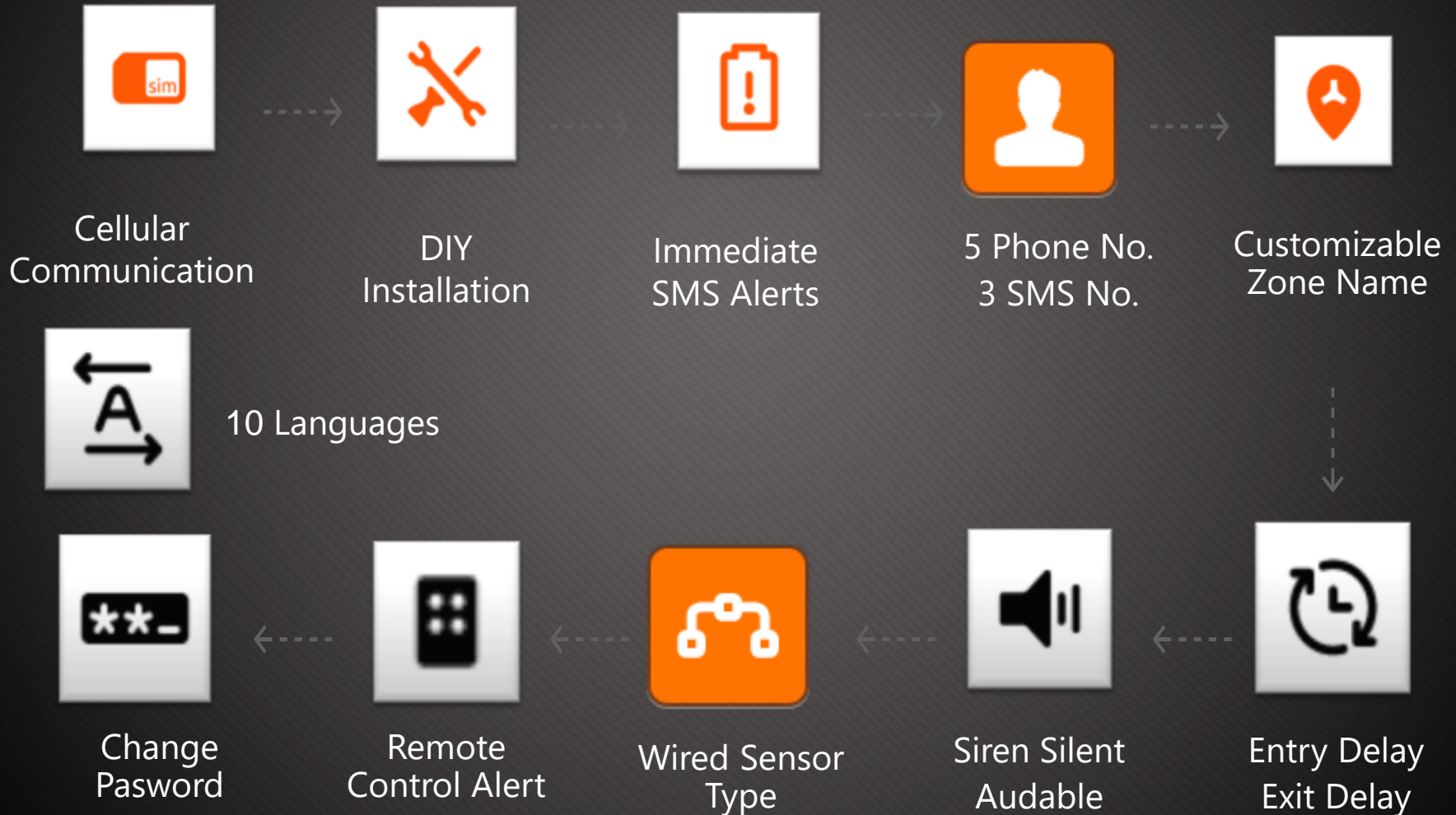

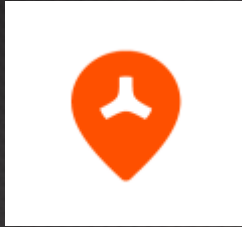

Customized
Zone Names



6

Wireless



2

Wired



2

24-Hour

maxkin



Alarm Management
by Different Groups



3

SMS



5

Phone





Ontips Mobile Apps



Ontips™

To help grow your business is our target
Our success is only possible with your success

MAXKIN

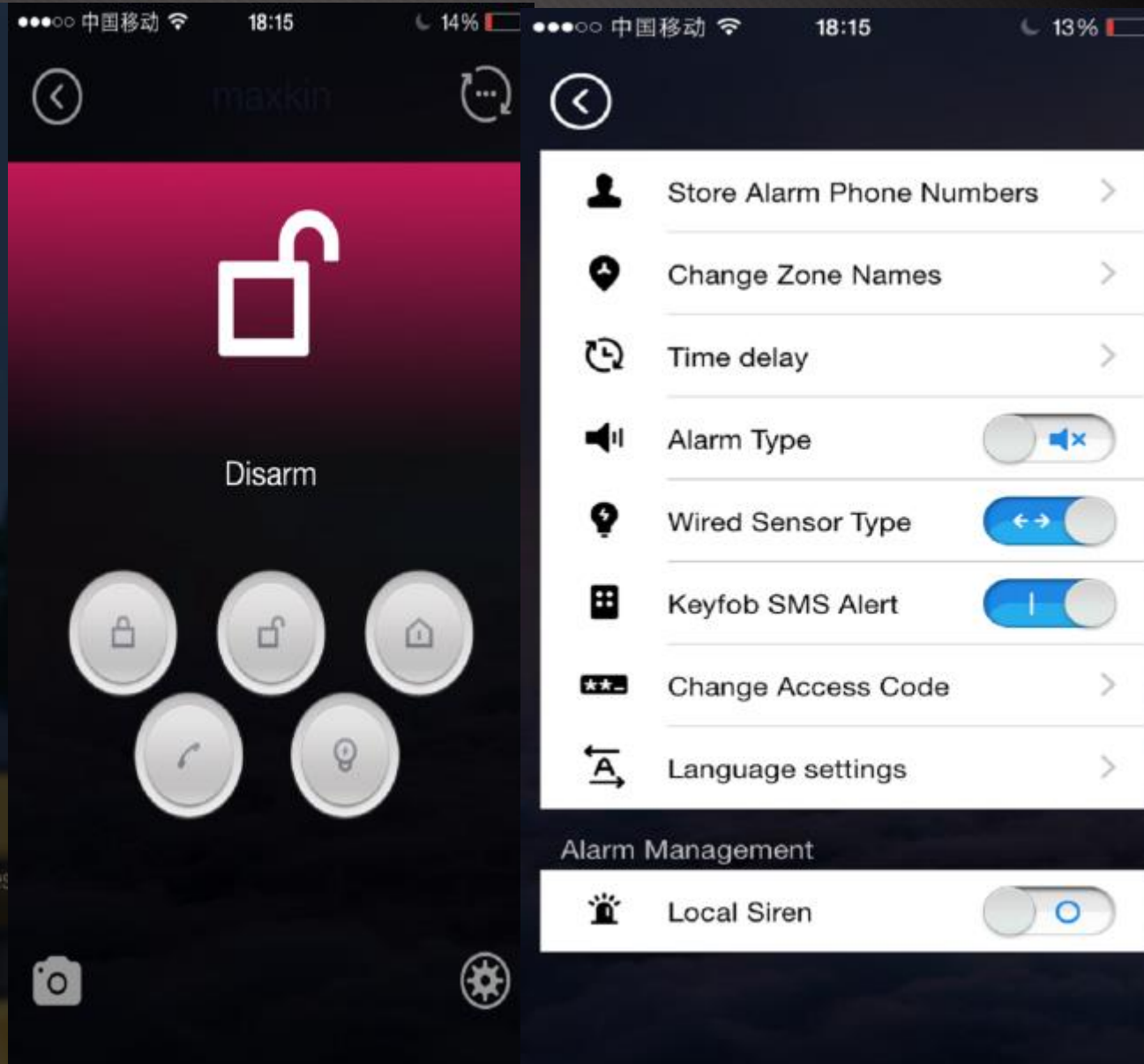

IP Camera

IP-100

- Image Format:
- H.264
- Resolution:
- 1280*720
- Frame Rate:
- 15FPS
- Built-in microphone
- 2-way audio communication)
- Built-in
- 802.11n wireless module and antenna
- Security:
- WEP/WPA/WPA2 encryption
- Power Supply:
- 5V-1A
- Operating Condition:
- 5° C-50° C
- Material:
- ABS + PC



Features



HD 720P



Night Vision



Motion Detection



Two-way talk

Micro SD

Have the option of saving footage directly to your IP camera, supports up to 32GB.



Two Way Talk

Talk and listen to pet and people via built-in mic and speaker.

Night Vision

View up to 26 feet in complete darkness with LED Array.

Installation: Put it anywhere

Standing



Wall



Magnet





Crystal HD Night Vision

120° Viewing Area



720P HD Video, Snapshots of Critical Moments

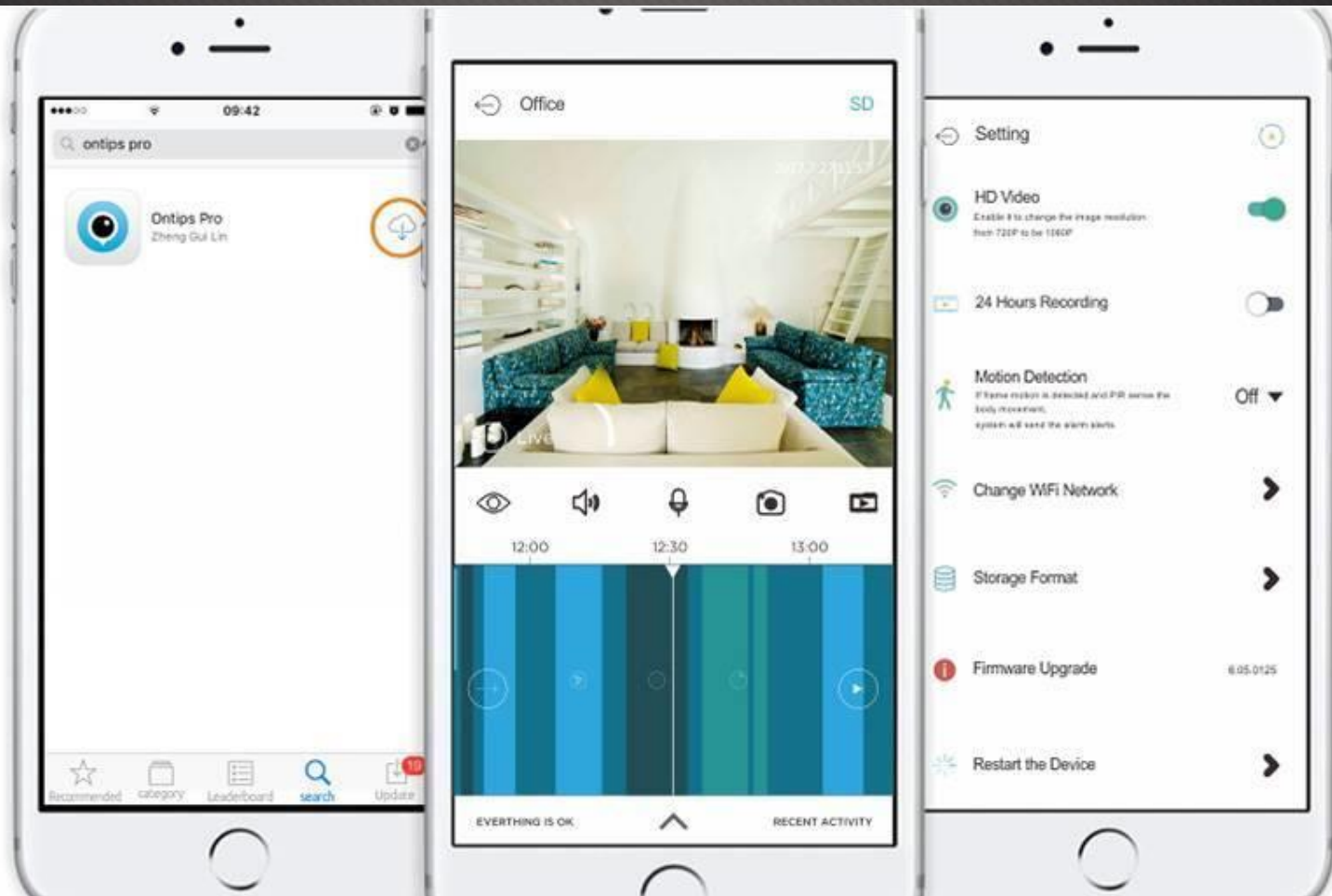

Tutti Mini Store Siren



Peach of Mind

To meet all the needs for protection and comfort in the home!

Functional Devices

Tutti, a partner of alarm system!



SOS Emergency Call



Strobe Siren



Wireless Kepad



System Status



On-site alarm system with other detectors

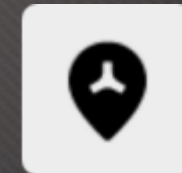

Zone Indication



Press 3 times
+ disarm button

Catalogues



PIR Motion Detector/Door Sensor



Arming/Disarming Device



Wireless Siren



IR Beams/Fences

Accessories



PIR Motion Detector



PIR-600
PIR Motion Detector



SS-P01 PLUS Pet Immune
PIR Motion & Door Sensor



PIR-602
Outdoor Triple
Technology Detector

Difference- PIR Motion Detector			
Model	PIR-600	SS-P01 PLUS	PIR-602
Type	Single-Tech	2 IN 1	Tri-Tech
Technology	Passive	Passive infrared & Door Contact	Microwave & Passive infra-red & MCU
Temperature Compensation	Active Dual-beams IR Sensors	Indoor	Outdoor or Indoor
Pet-immunity	NO	20kgs	20kgs
Anti-inference			Special optical filter lens, white light immunity at 10000 lux, insect immunity
Coverage area	8m/110°	8m/90°	12m/110°
Condition	Indoor	Indoor	Waterproof, Outdoor

Wireless Door/Window Sensor



DWS-300
Door/Window Sensor

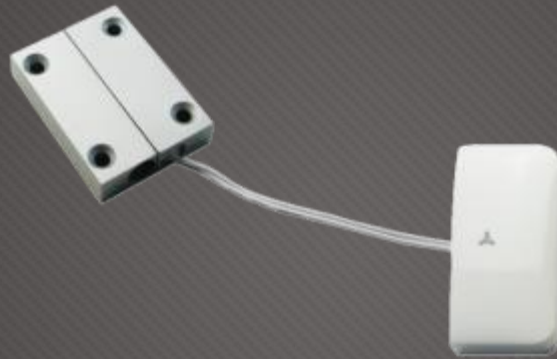

DWS-301
Iron Door/Window Sensor



DWS-302
Shutter Door Sensor



KP-A1 Keypad

Proximity operated keypad, for
arming/disarming,
panic alarms, electronic lock control...
Easy installation, user-friendly
programming
Duress code, multiple securities
Tamper protection
3 colored LED indication
Power: 1.5V AAA LR03 battery X3
Compatible with all types of MAXKIN
control panels



Digital Keypad:
arm/disarm system



RFID tag or card to disarm
system

Keypad Operation



Multi Key Functions

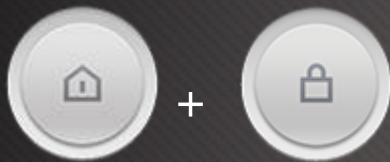

Mute Arm



Mute Disarm



Remote Control



Compact, comfortable, attractive new design, mysterious black

Built-in antenna

Multi-function operation

Power supply: DC6V

2* CR2032 Lithium Coin Battery

Transmit distance: $\leq 80\text{m}$ (open area)

WS-901 PLUS

External Strobe Siren



IP Grade

Robust weatherproof
(IP66)

Alarming Duration

30secs / 2 / 5 mins

Back up Lithium Battery

2200mA
9 days

Siren Volume

115dB
High / Low / Mute

Network & Sandalone Mode

Tamper protection

IB-400

Active Dual-beams IR Sensors (100 Meters)

Free from Trees, Brushes

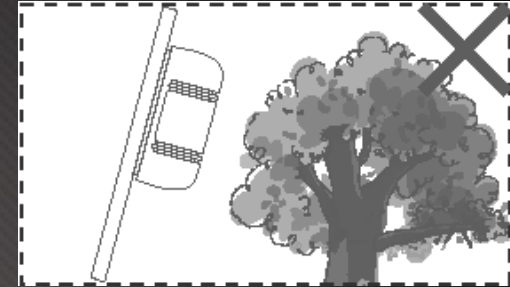

On a Firm Footing

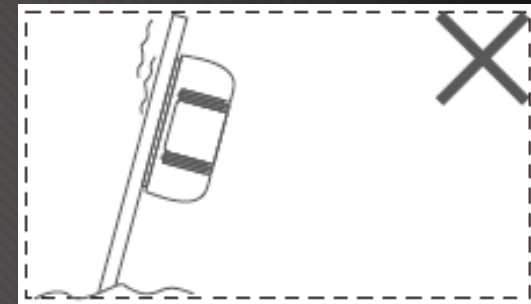

- For indoor and outdoor protection
- Easy to install and flexible
- Connect to control panel wirelessly
- Installation place: windows, walls, fences
- Detection: 60/80/100/200m optional
- Power supply: DC 12V
- Transmit distance: $\leq 80\text{m}$ (open area)

Installation Height

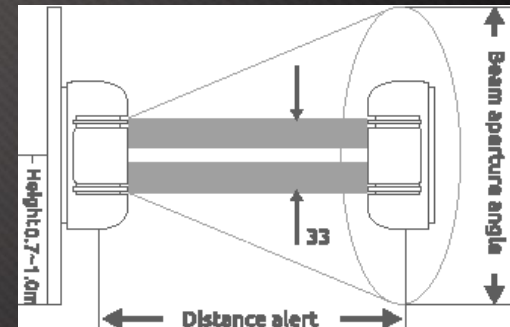



Thanks!